

CE

Electric fixed rack bakery oven - CF80



RUNI FX DD V2



577, rue Célestin Hennion
59144 Gommegnies
Tel : (33) 03 27 28 18 18
Fax : (33) 03 27 49 80 41
<http://www.eurofours.com>
email:infos@eurofours.com

SPEC SHEET : F9P-E000002-GB

Pictures are not contractual.
The company reserves the right to change any specifications without notice - Copying forbidden.

INSTALLATION

This machine is designed for professional use and therefore must be installed in a work space which is NOT ACCESSIBLE TO THE PUBLIC for obvious safety reasons

BEFORE THE INSTALLATION, MAKE SURE THAT :

- ✓ The equipment must be set up on a flat floor, with a sufficient safety allowable load.
- ✓ The oven will be installed on a **FIREPROOF SUPPORT (IMPERATIVE)** : wood, etc. ... BANNED for obvious safety reasons. The floor must withstand a minimum temperature of 300°C.
- ✓ The oven shouldn't be in touch with any wall. Keep at least:
 - ✗ Control board side : 10 mm to avoid condensation problems
 - ✗ Hinges side : 60 mm for door opening
- ✓ The room lay-out and the ventilation must comply with the legal standards.
- ✓ The wall clearance at rear of the machine is at least 100mm (400 mm if steam exhaust duct is at rear of the oven and not at the top) to ensure that oven works well.
- ✓ The free space above the machine is at least 300 mm.
- ✓ Important service area : service access to the technical part must be provided.
- ✓ An adequate natural airflow must be provided around the equipment
- ✓ The hood exhaust should have a sufficient natural draft with an adequate section.

POWER SUPPLY

Each oven must be individually protected with a system close to the appliance, easily accessible and in conformity with legislation.

Note : the EARTH continuity circuit must be provided between the appliance and its electrical connection.

The customer must install a differential circuit breaker (1 per oven).

The power supply voltage must match the indicated voltage specified on the nameplate.

WATER SUPPLY

Valve Ø 3/4" to 1 m above the floor, close to the equipment and easily accessible.

At the output of this valve, pipes and connection need to be prepared.

The water solenoid valve is equipped with a flow reducer. At 3 bar, the flow is about 3,3 L/mn. If necessary, the water flow can be increased by exchanging the reducer model.

In case the water analysis results are critical, it is highly recommended to apply water treatment in order to avoid scaling problems.

HOOD CONDENSATES DRAINING : Ø 20 mm

CONDENSATION DRAIN

The set : Elbow fitting Ø 3/4"MF + Reducer FF Ø 3/4"-Ø 1/2" + U-bend Ø 1/2", is supplied with the oven (to be fitted on the oven overflow pipe when installing).

STEAM EXHAUST

Oven outlet : tube Ø 153 mm. Pipes fitting : Female / oven side, male / outlet.

Hood :

- ✓ Air flow :
 - ✗ Low speed hood : 400 m3/h
 - ✗ High speed hood : 1000 m3/h
- ✓ Sound power :
 - ✗ Low speed hood : 58 dB(A)
 - ✗ High speed hood : 71 dB(A)

We draw your attention on the exhaust vent line. It **MUST** be installed and serviced by a **PROFESSIONAL CHIMNEY INSTALLER** due to the risks incurred when the exhaust vent line is not correctly built up and assembled.

The exhaust vent installer is just the sole person skilled to think about lengths, diameters, elbows, for the exhaust vent line according to the technical data of the equipment, local place, and the standards in force in the installation place environment.

The quality of the chimney draft has an influence on the baking quality.

We can under no circumstances be held responsible for any malfunction of the appliance due to an exhaust vent line which could not meet the requirements of the technical rules and the laws in force .

APPLIANCE CHARACTERISTICS

The oven is made of :

- ✓ A stainless steel sheet assembly forming the tighten chamber
- ✓ A glass door with closure by electromagnet.
- ✓ An external stainless steel shell
- ✓ A stainless steel front face
- ✓ An automatic hood with 2 speeds controlled by electronic (the frontage can be removed without any tool).
- ✓ An electronic control panel built in the door band



RUNI FX DD V2

Control of the following functions
(According to the oven equipment)

:

- ✓ Steam
- ✓ Exhaust vent (damper)
- ✓ Hood
- ✓ Energy saving

or



E-Drive : Touchscreen regulator (option)

Control of the following functions (According to the oven equipment) :

- ✓ Steam
- ✓ Exhaust vent (damper)
- ✓ Hood
- ✓ Energy saving
- ✓ Speed drive (option)
- ✓ Weekly planning
- ✓ 100 possible registered programs :
 - ✗ 1 manual program
 - ✗ 3 continuous baking programs
 - ✗ 96 recipes with 6 possible phases

Options :

- ✓ Voltage : ~3x230V+G (9P-12E030B***)
- ✓ Electrical protection (9P-12PROTELEC)
- ✓ Connection for centralized thermal management (9P-1200000GTC)
- ✓ A speed drive (9P-12V0000000)
- ✓ A reinforced steam system (9P-12DB000000)
- ✓ Steam exhaust connection kit from back :
 - ✗ oven 400x600mm - 460x660mm (9P-12RACE0Y00)
 - ✗ oven 400x800mm - 460x800mm (9P-12RACE0X00)



- ✓ Interior service ability (9P-12SAIEL000)

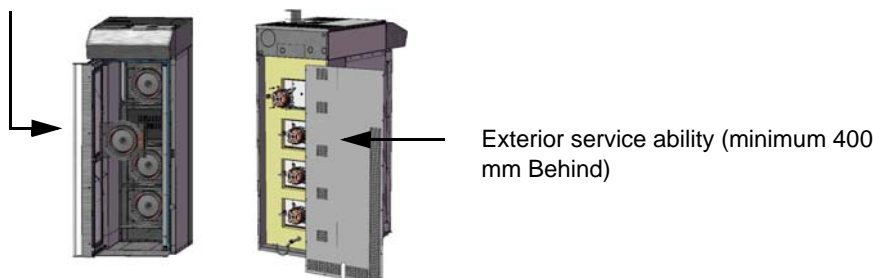

- ✓ Stopgap control «MINICOM» (9P-12TSE00000)



Control of the following functions : Steam, Exhaust vent (damper), Adjustment of set temperature.

or

- ✓ Energy saving function - Half load (9P-12DMCH0000)

- ✓ PAKAGING
 - * Pre assembled (9P-12MDD00000)
 - * Disassembled (9P-12D0000000)

3 POSSIBLE PACKAGINGS

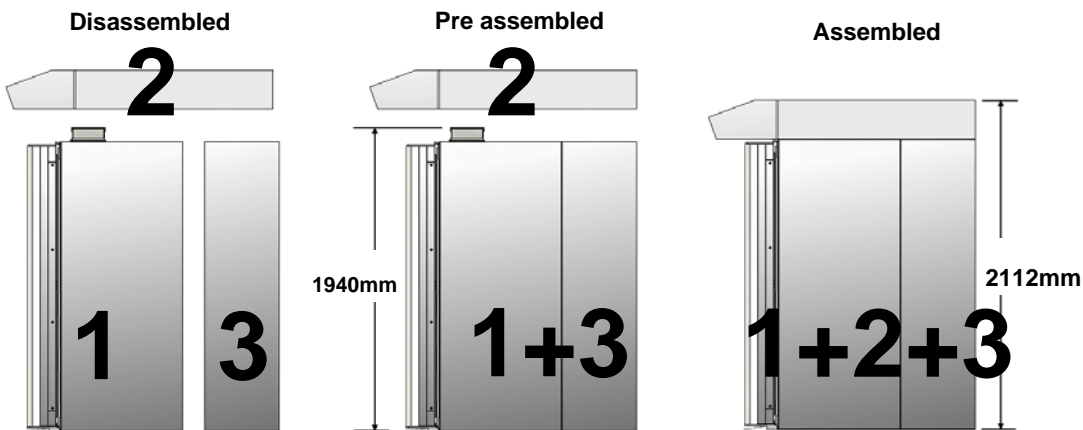

Configuration :	Assembled	Pre assembled - Disassembled
Handling pallet dimensions :	1500 x 850 x 150	1900 x 850 x 150
Package dimensions :	1500 x 850 x 2300	1900 x 850 x 2100

Pre assembled : Electric box located at the top of the oven but disconnected..
 Disassembled : Electric box located at the top of the oven but disconnected + Front and rear parts linked up with 4 screws for transportation.

DOOR HINGES

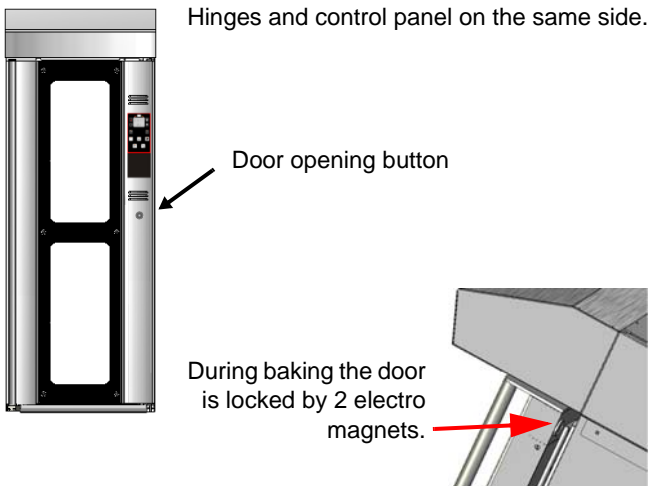

When the oven is installed against a wall :

- ✓ for an oven with door hinges wall side : 100mm are needed between the oven and the wall for the door opening
- ✓ otherwise, make door hinges forecast in the opposite side

In case of layout change in your room, the door can be reversed at low cost (only 1 door side to change) by your dealer.

Electric fixed rack bakery oven - CF80

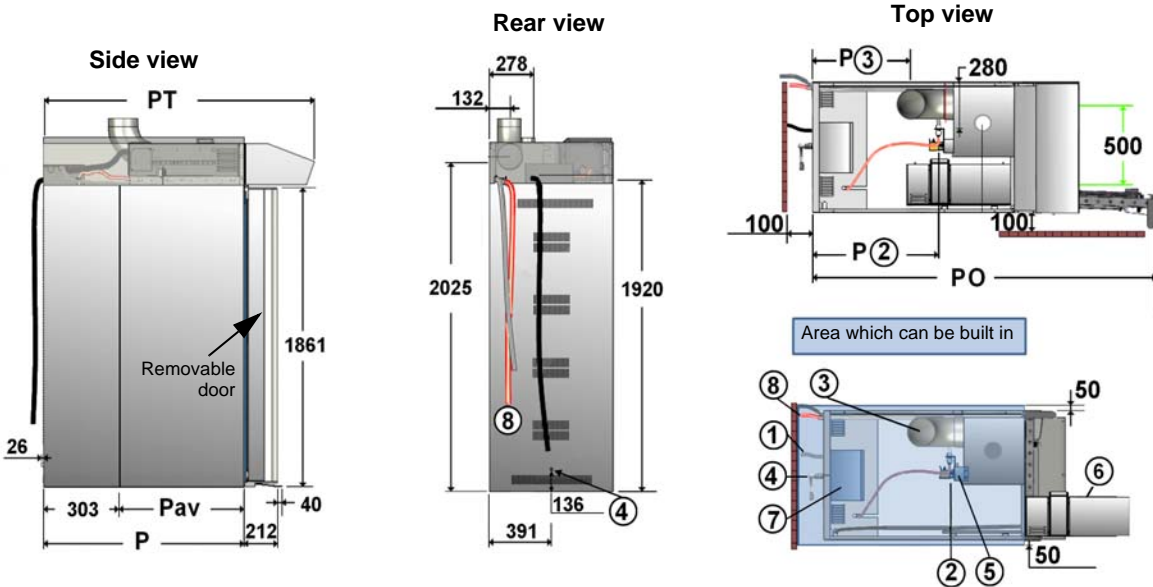
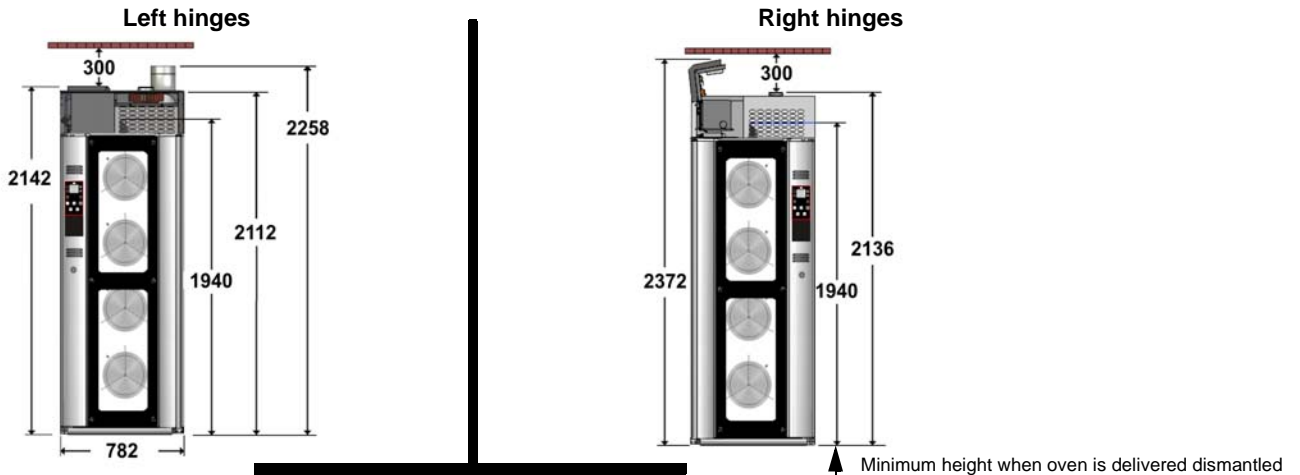

Connection kit for rear steam exhaust (option).

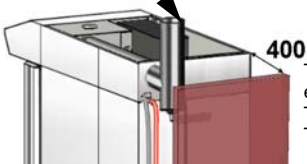

Inlets ① ② and outlets ③ ④ ⑧ are at customer's charge and have to be in-service the day of installation.

When the analysis results of water are critical, it is deeply recommended to treat the inlet water to avoid any scaling problem.

The wall clearance at rear of the machine is at least 100mm [400mm if steam exhaust duct is at rear of the oven and not at the top] to ensure that oven works well.

The free space above the machine is at least 300 mm.

The oven shouldn't be in touch with any wall. Keep at least 50 mm to avoid condensation problems.

① Electrical connection through junction box at 1 m of the coupling point

② Cold water connection \varnothing 3/4" : 3 bars mini - 5 bars maxi

③ Steam exhaust pipe : Hood outlet : tube \varnothing 153 mm

④ Purging \varnothing 3/4"+ reducer \varnothing 3/4"- \varnothing 1/2"+ U-bend \varnothing 1/2"

⑤ Exhaust vent motor

⑥ Slidding electric box

⑦ Electrical connection box

⑧ Hood condensates draining \varnothing 20 mm

Number of turbines : 4

Low speed hood :

Sound power : 58 dB(A) / Air flow : 400 m³/h

High speed hood :

Sound power : 71 dB(A) / Air flow : 1000 m³/h

Option : Energy saving function - Half load or «MINICOM» (Backup controller)

	9P12Y		9P12X	
Model	9P12F	9P12B	9P12A	9P12U
Trays dimensions	460X800	400X800	400X600	460x660
P	1195 mm		1055 mm	
Pav	892mm		752mm	
PT	1630mm		1490 mm	
PO	2019 mm		1879mm	
P②	710mm		570mm	
P③	791mm		651mm	
Weight Kg	500		450	

	Full power / Half load (option)	
Electrical power maxi (kW):	40,41 / 19,3	33,8 / 17,9
Heating power (kW):	37,8 / 16,8	31,5 / 15,2
Intensity (A):		
-3x400V+N+G	58,3 / 27,9	48,8 / 25,8
option -3x230V+G	106 / 48,4	88,7 / 44,9

REAR VIEW / CONNECTIONS PRINCIPLE



The oven must be aerated in an ambient atmosphere below 32°C (90°F), to ensure its proper operating. Do not obstruct the oven ventilation grids.

Steam exhaust pipe
1 m mini - Ø 153mm

NOT SUPPLIED WITH THE OVEN

Water solenoid valve

Slidding electric box

Stainless steel elbow fitting F-F Ø153

Slidding electric box

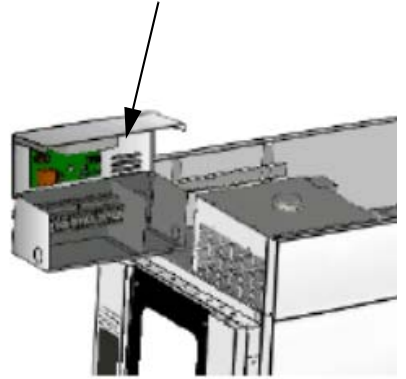

Electrical connection box

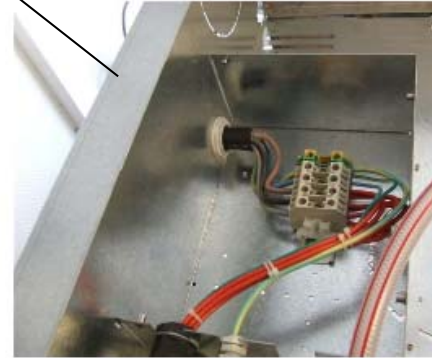

Hood condensates draining

Water supply

Electric power supply

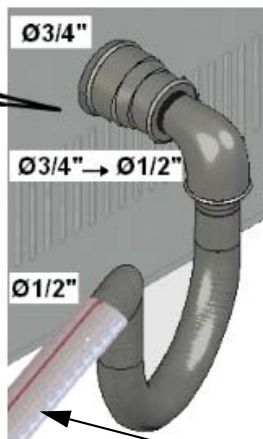

Reducer FF Ø 3/4"-Ø 1/2"
Elbow fitting Ø 3/4"MF
U-bend Ø 1/2"

Condensate draining to the sewer

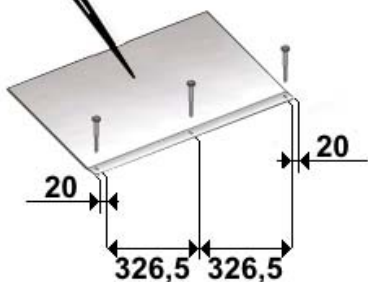

Fixing of the loading ramp to the floor



Seal with high temperature silicone and then cover with aluminium scotch

NOT SUPPLIED WITH THE OVEN

Pipes fitting : Female / oven side, male / outlet.

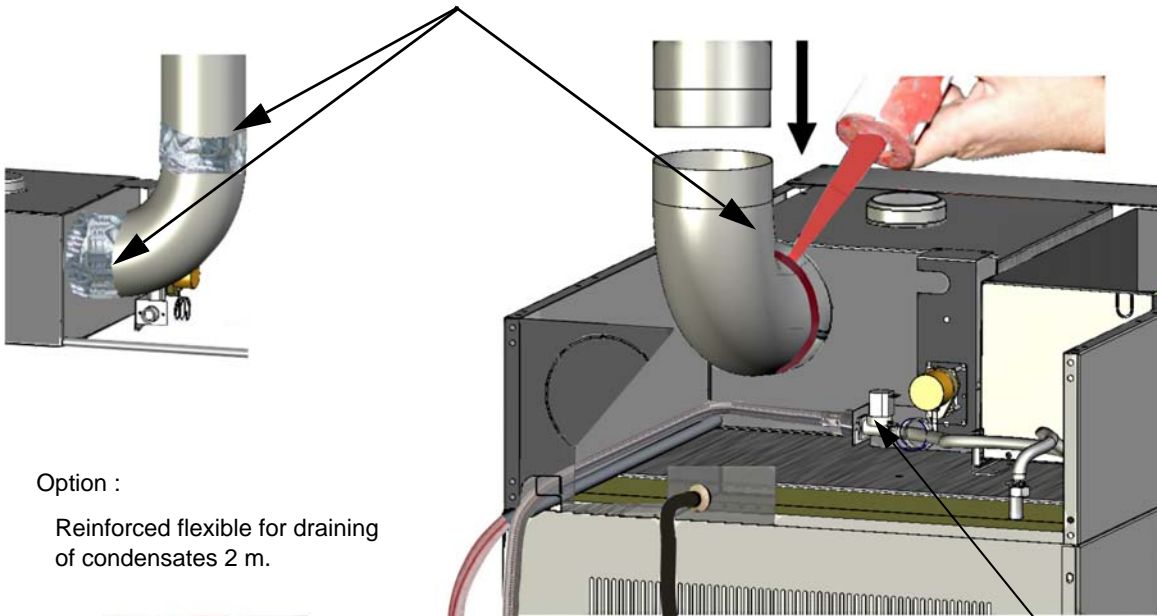

Option :

Reinforced flexible for draining of condensates 2 m.



1 x Stainless steel hose for water inlet 3 m

Connect :

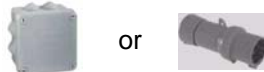

or

NOT SUPPLIED WITH THE OVEN

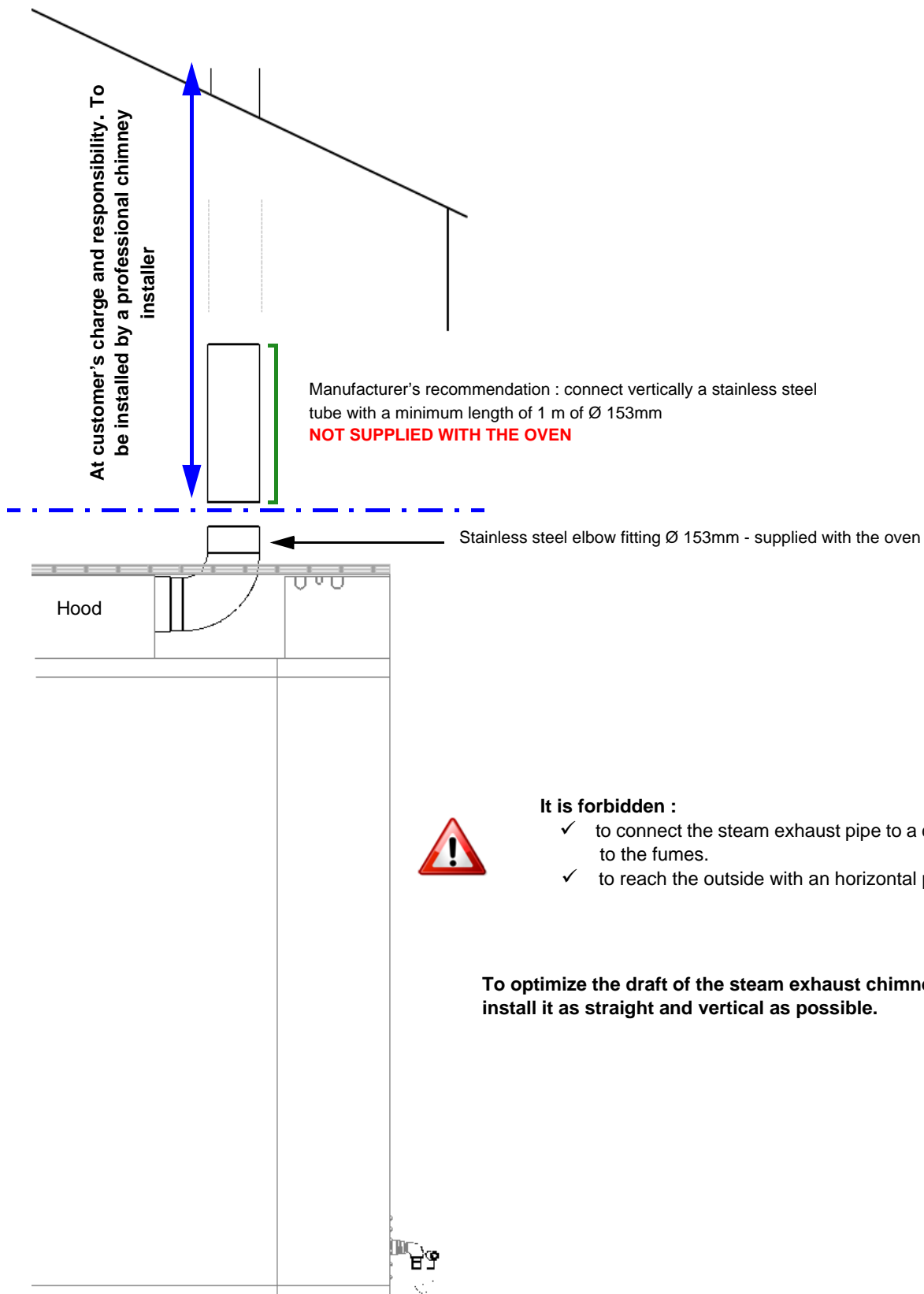

OPTION : STEAM EXHAUST CONNECTION KIT FROM THE BACK

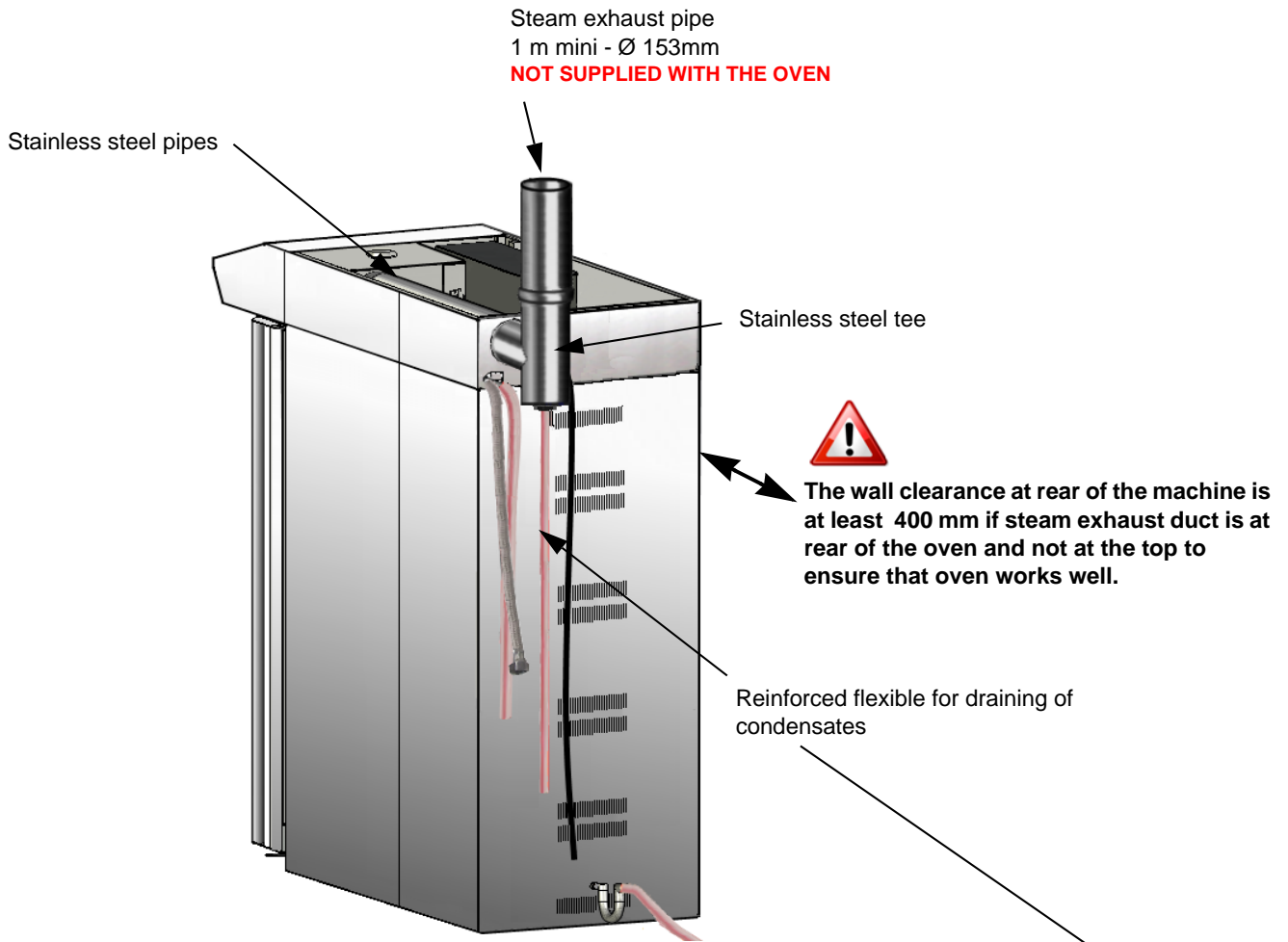

Not supplied with the oven



Replaced by :

OVEN : 400x600mm - 460x660mm
OPTION : Ref : 9P-12RACE0Y00/1



1 x 500mm

+



1 x 330mm

+



1 x Stainless steel tee



+ 1 x 2 m

OR

OVEN : 400x800mm - 460x800mm
OPTION : Ref : 9P-12RACE0X00/1



1 x 1000mm

+



1 x Stainless steel tee



+ 1 x 2 m

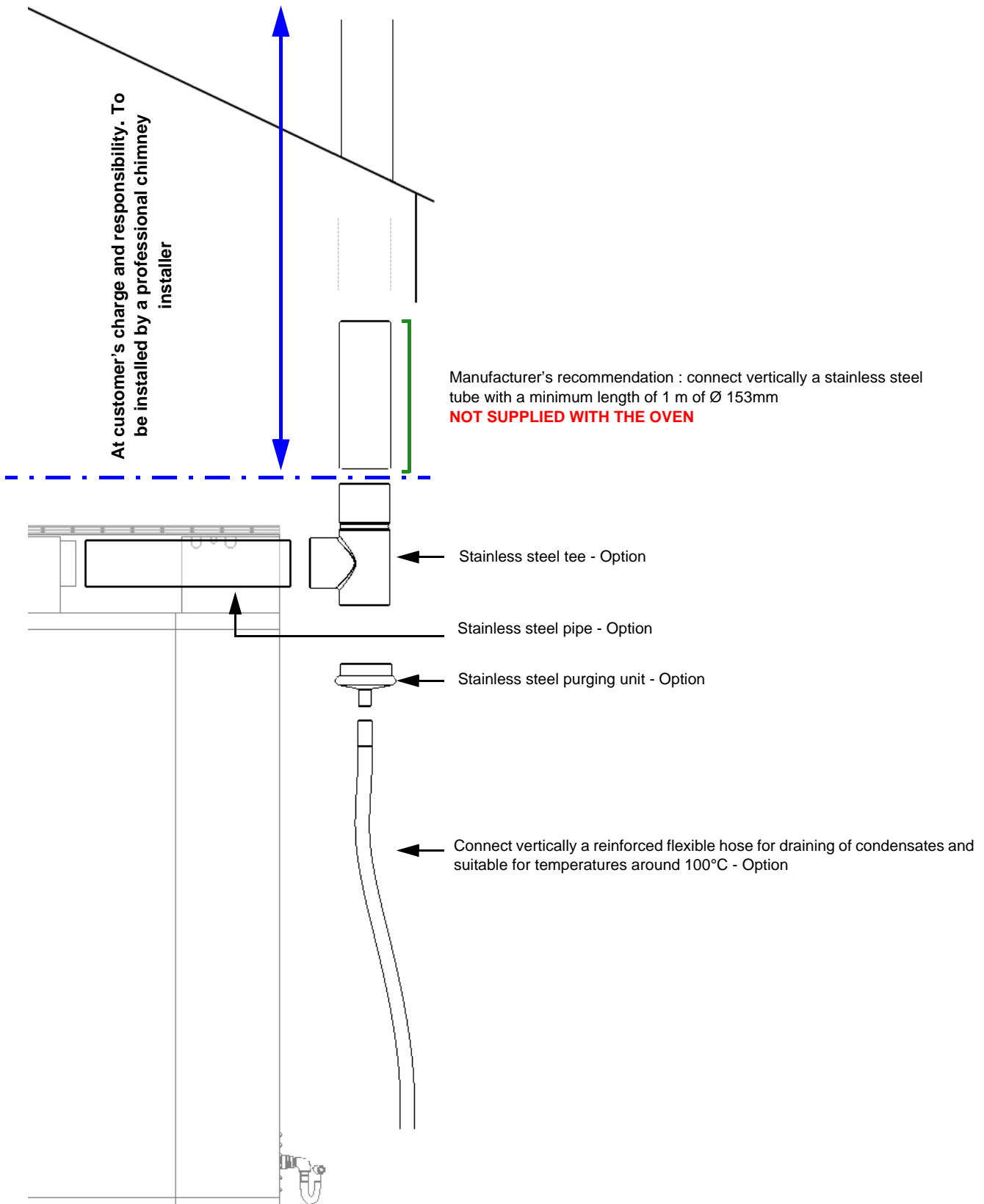

It is forbidden :

- ✓ to connect the steam exhaust pipe to a chimney dedicated to the fumes.
- ✓ to reach the outside with an horizontal pipe.

To optimize the draft of the steam exhaust chimney, you must install it as straight and vertical as possible.

TROLLEYS CHARACTERISTICS

Trays dimensions	400x600mm	400x800mm	460x660mm	460x800mm
A	463mm		530mm	
B	411mm		475mm	
C	648mm	848mm	702mm	848mm
e	16 levels : 95mm - 12 levels : 125mm			

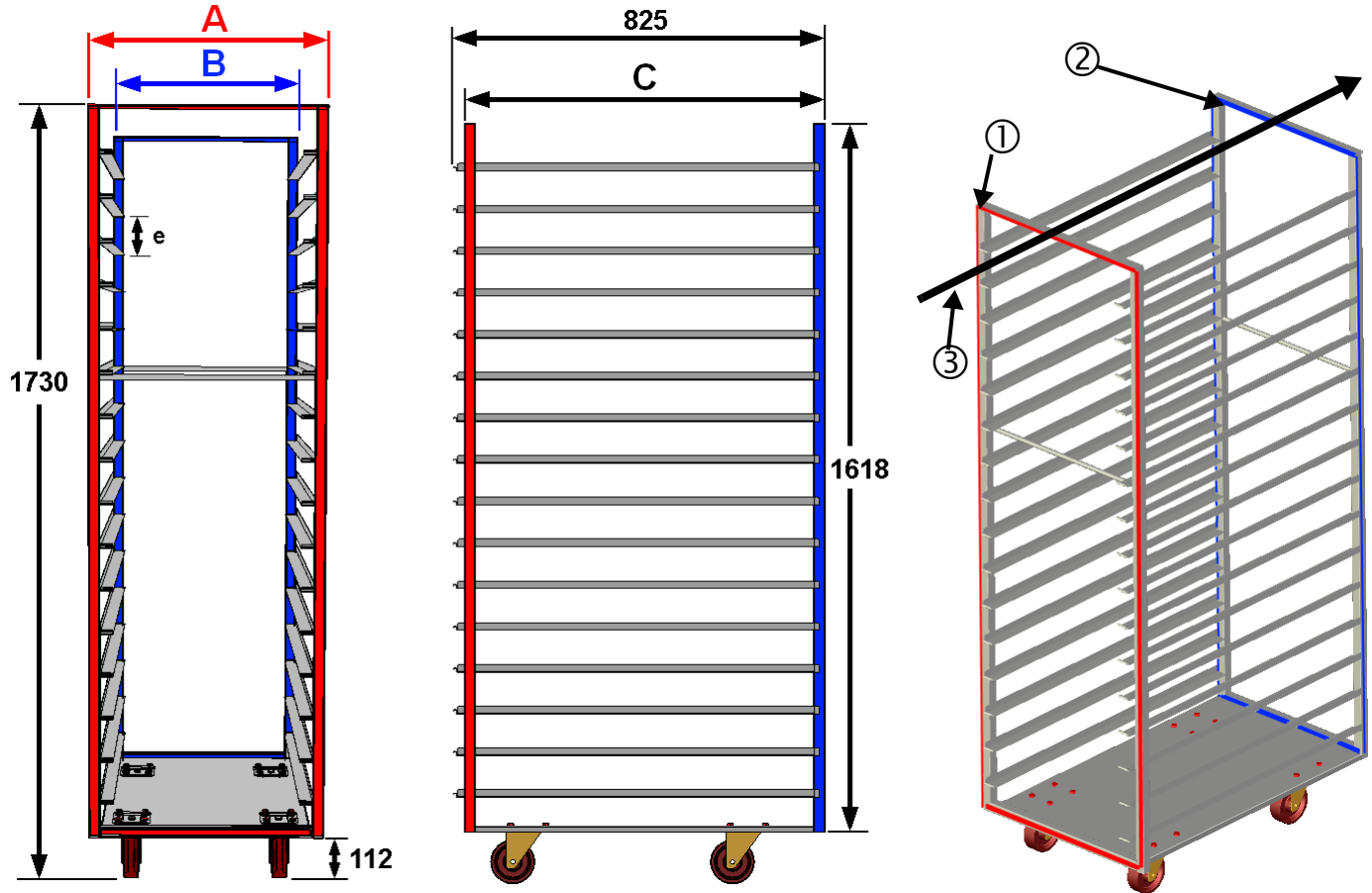

- ① Front part of the trolley larger than rear part. Trays are inside the frame.
- ② Rear part of the trolley less large than front part. Trays are in line with the frame
- ③ Way to insert the trolley in the oven

With competitors trolleys :

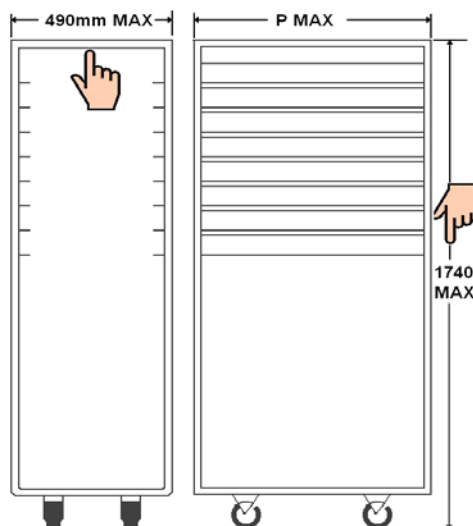

P MAX :

- ✓ 690 mm : trays 40x60
- ✓ 825 mm : trays 40x80

BEFORE UNDERTAKING ANY WORK ON THE EQUIPMENT



**Before undertaking any work on electrical parts, disconnect the supply to the appliance at the external disconnecting switch.
Beware of residual voltage.**

To disconnect the appliance from the electric plug, never pull the wire.



DO NOT TOUCH THE APPLIANCE

**With any wet or damp body parts.
If you are barefoot.**

All work on the equipment must be done by a qualified and approved professional.
In the event of false alarm in the safety system, you must contact your supplier.

WATER QUALITY

Although if clean and safe for consumption, the water supplied can have a bad taste (caused by the chlorine), be corrosive or cause calcareous deposits.

After analysis, when the water characteristics reach critical levels, it is imperative to install a water treatment system upstream to increase the life duration of your equipment.

Depending on the concentrations of chloride, carbonate and the pH value, it may also be necessary to treat water to reduce the corrosion risks

A system of water treatment is strongly recommended in the following cases :

- ✓ if the water hardness is greater than or equal to 15°f : Hard water. It is a calcareous water that generates a very important scale deposit especially in hot condition (60°C).
- ✓ if it is a very soft water (TH<9°f) and a pH more than or equal to 7 : Corrosive water termed aggressive. Aggressive water involves the metal rust. The soft water corrosiveness is increased when its pH is acidic.
- ✓ if the pH is less than 6.8 or more than 7.5.
- ✓ for high concentrations of chlorides or nitrates.

Depending on water analysis results , various solutions are possible : neutralizing filters , water softener, activated carbon filters, ... A water treatment specialist will be able to propose you a solution in compliance with your installation and based on the water analysis results.

Once the treatment system installed, check its effectiveness through further analysis of the water.

The regular system maintenance as per the manufacturer's recommendations is imperative to maintain permanently a water quality suitable with the equipment.

The sediments presence in water is another factor to take into consideration. In such a case, a mud filter has to be added to the system.



If your water does not meet these quality criteria it may cause a malfunction even the degradation of the appliance. Non complying with the above mentioned requirements may result in voiding the warranty.

N.B : The water hardness is its calcium and magnesium content. The hydrotimetric title (TH) is measured in French degrees (°f): 1°f = 4 mg of calcium + 2.4 mg of magnesium per liter.